

Logging In

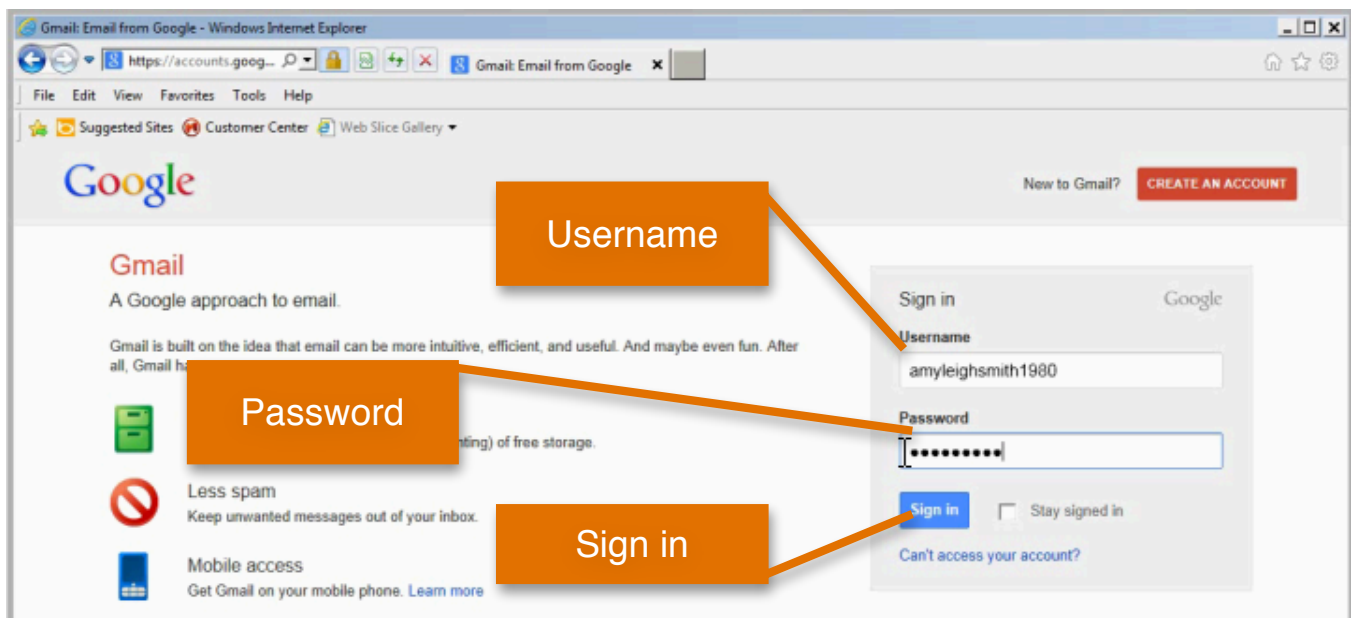

Amy has been using Gmail for a little while now and is about to login to check her email account.

She types gmail.com into the address bar of her browser and hits enter.

On the Gmail login page, she will type the first part of her email address (the part that comes before @) into the box labeled username.

Next, Amy types in her password.

Once Amy has entered her username and password, she clicks on the blue button that says “Sign in”.